

# BJELIN

## Woodura Planks 3.0

HARDENED TIMBER | AWARD-WINNING INNOVATION





# Born in *Scandinavia*. Lived on in *Australia* and *New Zealand*.

Scandinavians are known for their love of nature and balanced way of living, much like life in Australia and New Zealand.

Sharing a deep connection to the environment and a focus on simplicity and sustainability, we've created long-lasting flooring that reflects these values – natural, beautiful and built to last.

XL | 206 x 2200 x 11.3mm  
Misty White, Nature (Oak)

## Woodura Planks <sup>3.0</sup>

# Built to last. Designed to impress.

Woodura Planks 3.0 provide a gorgeous and durable foundation for any household. Strengthened by patented technologies, they thrive in lively settings, creating warm and inviting atmospheres.

Their natural beauty and grain patterns bring an authentic and timeless feel to any interior. Exceptionally tough and resistant to dents and water, these floors are made from responsibly sourced FSC™ certified European wood, ensuring a long lifespan.

These floors have truly revolutionised home living.



**100%  
REAL WOOD**



**3X STRONGER  
IMPACT RESISTANCE**



**HIGHLY WATER  
RESISTANT**



**SUSTAINABLE  
MANUFACTURING**



HARDENED TIMBER



# Responsible flooring packed with world-class innovations.

Our exceptionally durable hardened wood floors are empowered by the patented Woodura™ technology, which creates a water and dent resistant surface and makes the panels three times stronger. Together with the leakproof 5G Dry™ floor locking system and the moisture-resistant Compositek wood core, these floors can last for generations. Produced with high-quality, responsibly sourced FSC-certified wood, all raw materials are used optimally, creating a more sustainable wood floor.

woodura™

## Product build-up

1. Pro matt lacquer top coat
2. Natural wood covering
3. Wood-based powder layer
4. Välinge Compositek™ core
5. Wood-based powder layer
6. Wood backing layer





HARDENED TIMBER

# XXL | *The Art of Scale*

BJELIN's Woodura 3.0 XXL planks redefine luxury through proportion and presence. Crafted for expansive spaces, they bring a sense of calm and sophistication to any interior. The extended length and width enhances natural flow, while advanced engineering ensures enduring strength and lasting beauty.

XXL | 271 x 2378 x 11mm  
Shadow Brown, Nature (Oak)





**XXL** | 271 x 2378 x 11mm  
Natural, Nature (Oak)



**XXL** | 271 x 2378 x 11mm  
Misty White, Nature (Oak)



**XXL** | 271 x 2378 x 11mm  
Shadow Brown, Nature (Oak)





XXL | Natural, Nature (Oak)





HARDENED TIMBER

# XL | Crafted for *contemporary living*

BJELIN's Woodura XL planks balance elegance with performance. Perfect for modern interiors, their generous proportions showcase the beauty of real timber. Each plank is engineered for strength, delivering a refined finish that stands up to everyday life.

XL | 206 x 2200 x 11.3mm  
Natural, Nature (Oak)





**XL** | 206 x 2200 x 11.3mm  
Natural, Select (Oak)



**XL** | 206 x 2200 x 11.3mm  
Misty White, Select (Oak)





**XL** | 206 x 2200 x 11.3mm  
Earth Grey, Nature (Oak)



**XL** | 206 x 2200 x 11.3mm  
Terra Brown, Nature (Oak)





**XL** | 206 x 2200 x 11.3mm  
Hard Smoked, Nature (Oak)



**XL** | 206 x 2200 x 11.3mm  
Natural (Walnut)



**XL** | 206 x 2200 x 11.3mm  
Terra Brown (Walnut)





XL | Shadow Brown, Nature (Oak)



A photograph of a young child with blonde hair, wearing a blue and white striped shirt and light grey pants, sitting on a light-colored wooden floor. The child is playing a small black toy piano. A potted plant is visible in the background. The text 'HARDENED TIMBER' is centered at the top.

HARDENED TIMBER

# S | *Beautifully compact*

BJELIN's Woodura S planks deliver the beauty of real timber in a perfectly proportioned format. Ideal for smaller spaces, the S format delivers effortless installation and exceptional durability.

S | 151 x 1170 x 9.2mm  
Natural, Blended (Oak)





**S** | 151 x 1170 x 9.2mm  
Natural, Blend (Oak)



**S** | 151 x 1170 x 9.2mm  
Misty White, Blend (Oak)



**S** | 151 x 1170 x 9.2mm  
Powder White, Blend (Oak)



**S** | 151 x 1170 x 9.2mm  
Earth Grey, Blend (Oak)





**S** | 151 x 1170 x 9.2mm  
Terra Brown, Blend (Oak)





# Timber that *performs.*

Advanced **BJELIN Hardened Timber** construction transforms the way designers and architects can apply natural materials in commercial projects, combining tactile warmth with exceptional durability and ease of maintenance.

The manufacturing process fuses the core and the wooden top layer, compressing and hardening the wood fibers on a cellular level – creating a timber that performs in commercial spaces.



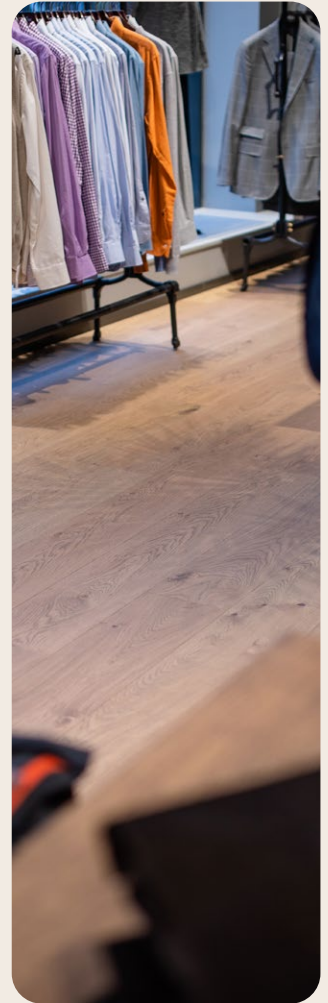

From dance studios to retail spaces, and even events venues – BJELIN Hardened Timber is a game changer in delivering a beautiful natural timber flooring option into commercial spaces.







#### **CASE STUDY: RESERVE HOUSE**

Step inside Reserve House – a contemporary Australasian family home where everyday living meets exceptional design. Featuring BJELIN Woodura 3.0 Hardened Timber, this residence proves that true beauty can also be brilliantly durable – with up to three times greater impact resistance than traditional engineered timber flooring.

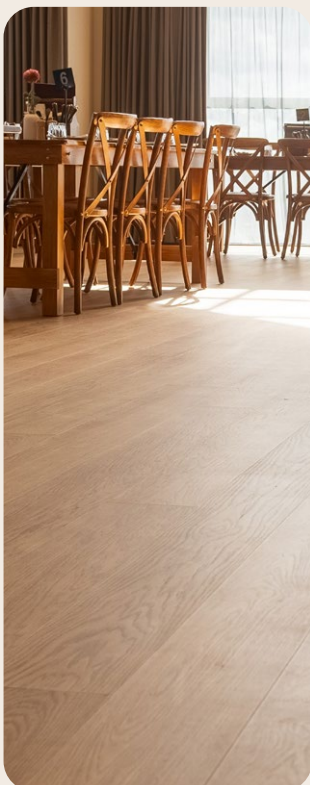

#### **CASE STUDY: TATUM EVENTS PAVILION**

If it can handle an event centre, imagine what it can do in your home! Engineered for life's toughest demands, BJELIN Hardened Timber brings commercial-grade strength to residential style. With impact resistance up to three times greater than traditional timber, it's a floor that performs beautifully – whether under dancing heels or everyday footsteps.



## Diverse gradings and colours for multiple interiors.

Choose a Select grading for a clean look or the authentic Nature option for a little more character. Meanwhile, our pro matt lacquer surface treatment stands up to the toughest demands, making it ideal for both residential and commercial settings.

### Select

Select is clean and harmonious, with few whole knots and color variations.



### Blend

Blend mixes the clean and sophisticated Select with the character of Nature.



### Nature

Nature brings the beauty of the outdoors inside, providing an authentic wooden look.





# Easiest installation on the market.

Assemble your floor planks effortlessly with a satisfying click. Our Woodura Planks 3.0 boast the patented 5G Dry® solution, developed by sister company Vålinge Innovation, creators of the first mechanical floor locking system.

## 5G Dry – a leak-proof solution

The leak-proof 5G Dry floor locking system is the latest innovation in floor locking technology. In addition to providing a swift and hassle-free installation, watertight joints prevent water from seeping through the seams and damaging the subfloor.

This locking system has been developed to pass the NALFA and ISO Topical Moisture tests used to assess the behaviour of flooring installations exposed to water and spills. Our Woodura Planks 3.0 meet all the requirements of ISO 4760.

## Installation area

Installation is suitable for most residential and commercial areas, except in toilets.

## Area of application

European hardened timber products are suitable for most residential living areas, offices, hospitality, retail etc. The flooring is not suitable for installation in humid rooms (bathrooms, saunas etc.).

Lacquered – suitable for installation in most heavy commercial and residential applications, except bathrooms.

## Cleaning

For the removal of dirt and grime, it is recommended to clean BJELIN's hardened wood with a pH-neutral hardwood surface spray and microfibre mop.

## Underfloor heating

These floors are suitable for underfloor heating. The surface temperature of the floor must never exceed 27° C. See installation instructions. Ensure you follow the installation guidelines and recommendations.

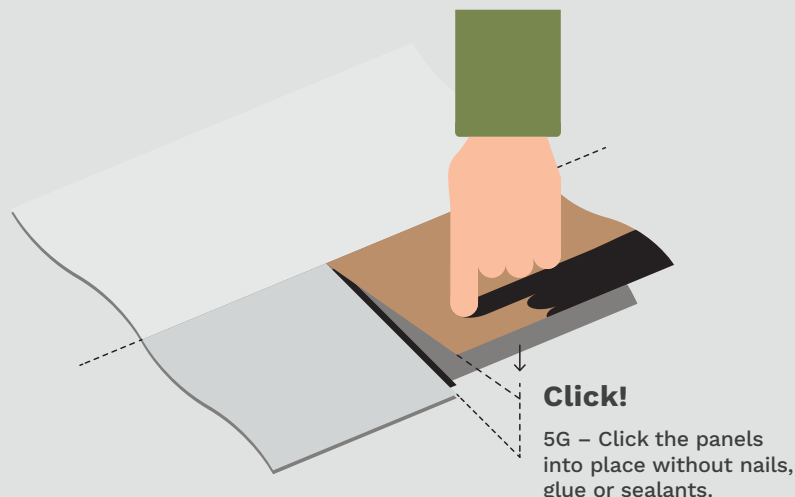



## TECHNOLOGIES

The 5G® locking system makes it easier than ever to click together a floor. Do it yourself or minimize the project timeline when hiring a professional. Can be installed as a **floating floor** or **glue down**.

©Välinge Innovation AB 2024. All trademarks herein are invented or registered and owned by Välinge Innovation AB. Technologies are subject to patent protection (see [www.valinge.se/patents](http://www.valinge.se/patents)). Nothing herein grants any right to use a technology or trademark without license.





## Belgotex Aqua Elite Underlay

Engineered to significantly reduce both reflected footfall and transmitted noise from upper-story traffic, Aqua Elite ensures a serene and peaceful environment below. Whether you're walking softly or bustling around, this underlay keeps your space quiet and comfortable.

Engineered to significantly reduce both reflected footfall and transmitted noise from upper-story traffic, Aqua Elite ensures a serene and peaceful environment below. Whether you're walking softly or bustling around, this underlay keeps your space quiet and comfortable.

Designed to work seamlessly with underfloor heating and cooling systems, Aqua Elite offers year-round comfort. When installed over a flat, smooth sub-floor, it provides a firm, luxurious feel underfoot, enhancing the longevity and performance of your new floor for years to come.





## SPECIFICATIONS AND ACCESSORIES

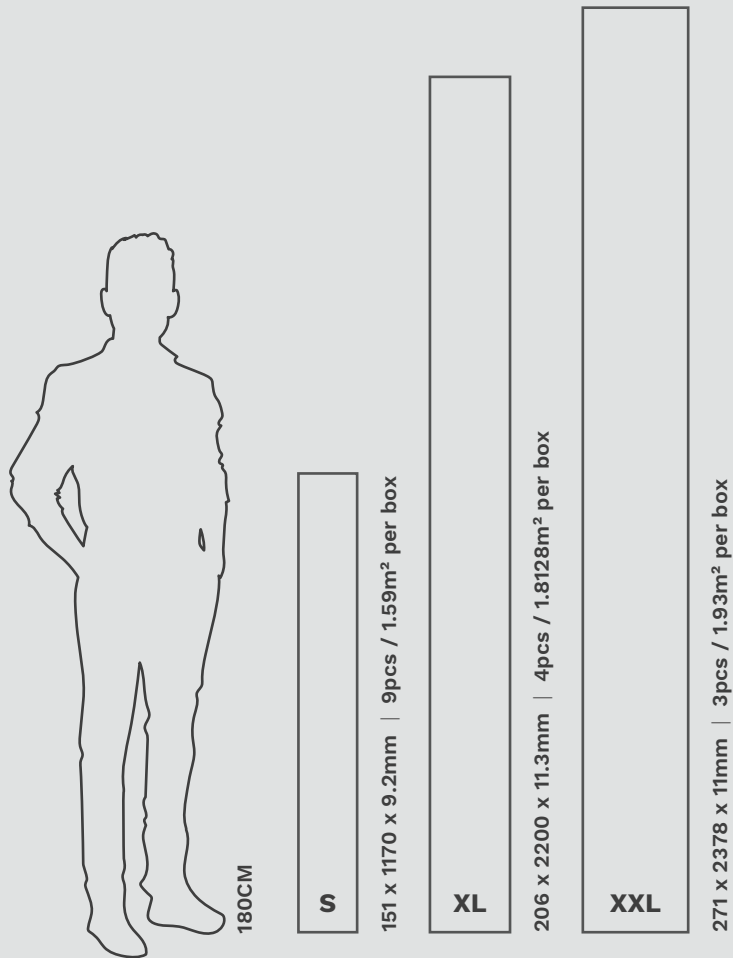

Commercial warranty available on request.

Full care and maintenance can be found at [belgotex.com.au](https://belgotex.com.au)

## Accessories



### Reducer

This lacquered Reducer is crafted from spruce and responsibly sourced FSC-certified oak veneer available in all stocked colours.

Use the Reducer to transition between areas with varying room or floor levels.

**Height** 12mm

**Width** 42mm

**Length** 2400mm



### T-Mould

This lacquered T-Mould is crafted from spruce and responsibly sourced FSC-certified oak veneer available in all stocked colours.

The T-Mould offers an attractive transition, concealing joints between floor surfaces.

**Height** 10mm

**Width** 44mm

**Length** 2400mm



### Stair Nosing

Designed for closed staircases, crafted from FSC-certified oak in Croatia and patented by Välinge Innovation, available in all stocked colours.

BJELIN's stair nosing enhances the aesthetic appeal of your

**Height** 80mm

**Depth** 18mm

**Length** 1000mm

**Please note that this stair nosing is not compatible with Bjelin's engineered parquet flooring or engineered herringbone parquet.** This stair nosing is designed to be installed with Woodura Planks 3.0 and is compatible with the 5G Dry floor locking system.



# Pioneering the future of flooring.

BJELIN develops, manufactures and sells a broad range of flooring products utilising ground-breaking technologies by sister company Välinge Innovation, the inventor of the click floor. Production takes place in our state-of-the-art factories in Sweden and Croatia, where we have access to top-quality, FSC-certified wood. With a commitment to innovation, we thrive on challenging the norm, looking for new ways to enhance the customer experience, and finding environmentally friendly ways to create flooring products.

Belgotex | BJELIN Distributor

# BJELIN

**bjelin.com**  
**belgotex.com.au**

 [bjelin\\_flooring](#)  [Bjelin](#)  [Bjelin](#)  [Bjelin](#)  [Bjelin](#)